

# specification & information sheets

## ST chairs

# informationsheet

## ST chairs

linking module for ST06 & ST05 chairs



### Overview

ST chair's incorporate and comply with the latest aspects of European furniture design as influenced by the new European Education furniture standard EN1729 . EN1729 was devised to address, and reduce the pain endured by many students associated with poorly postured, incorrect sized furniture. EN1729 relates specifically to classroom seating, and deals with the strength and stability of a chair, as it does the ergonomics associated with people of different sizes, sitting in that chair being used at a desk or table.

ST chair's have been designed for individual wellbeing and comfort. Comfortable, Hard Wearing, Easy to Handle, Purpose built furniture for today's student. Peace of mind for those that purchase and maintain that furniture

### Fabrication

Injection moulded Co-polymer Polypropylene seat shell textured to hide scratching and reinforced with in -mould structural ribs. Linking device mechanically fixed to the seat shell.

### Material

Seat shell manufactured from hardwearing co-polymer polypropylene.  
Floor glides manufactured from moulded non skid polyethylene. (Different front and rear tip to aid in stacking)  
Steel legs manufactured from 16 gauge flat oval mild steel, powder coated silver.  
Linking device manufactured from engineering grade moulded nylon.

### Compliance

Chairs comply to EN1729 parts 1 & 2 compliant for strength and stability and dimensional.

### Colour & Product Code

Link only available in black.

Linc Furniture Pty Ltd PO Box 856, Newport, NSW Australia  
P +61 419 257 254 F +61 2 9997 8114  
E sales@lincfurniture.com.au www.lincfurniture.com.au

Specifications subject to change without notice

Codes when fitted to ST06 & ST05 chairs follow;

ST06 chairs with shell colours in: Slate (STLINK06SLA), Teal (STLINK06TEA), Soft Blue (STLINK06SBL), Primary Blue (STLINK06PBL), Plum (STLINK06PLU), Soft Lime (STLINK06SLI)

ST05 chairs with shell colours in: Slate (STLINK05SLA), Teal (STLINK05TEA), Soft Blue (STLINK05SBL), Primary Blue (STLINK05PBL), Plum (STLINK05PLU), Soft Lime (STLINK05SLI)

All Chair Frame Colours: Silver

### Stacking

The inclusion of a link has no effect on the way the chair stacks, and or stack height of either ST06 or ST05 chairs. Refer Specification sheet for stacking details for each product.

### Weight

ST06 with Link (PP) 4.2kg  
ST05 with Link (PP) 4.1g

### Options

Trolley. Product code WAGCTROLLEY

### Assembly

None Required if supplied fitted at time of order, other wise two screws used to secure each link to the side of the seat shell. Total four fixings per chair.

### Installation

Can be retrofitted to existing ST05 and ST06 chairs.

### Warranty

5 year manufacturers warranty.

**linc**  
FURNITURE®

# specificationsheet

ST chairs

size mark 6— 460mm seat HT

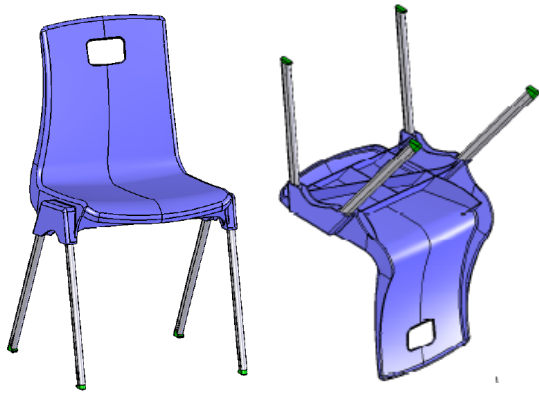

Model number ST06

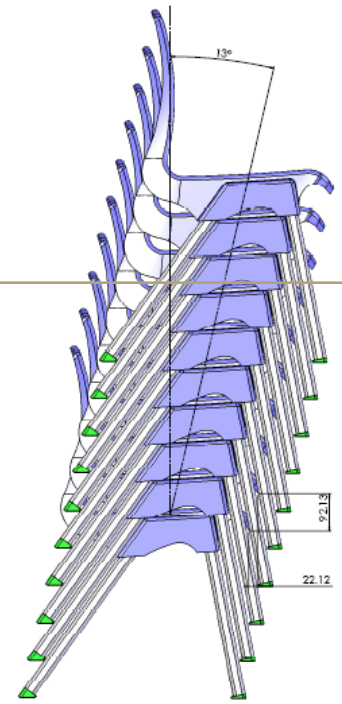
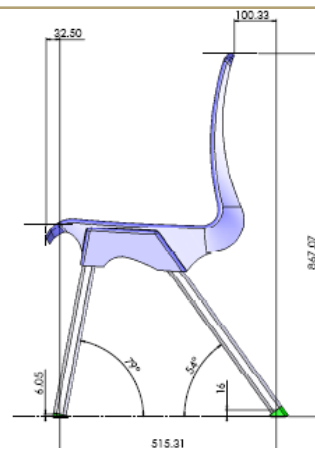
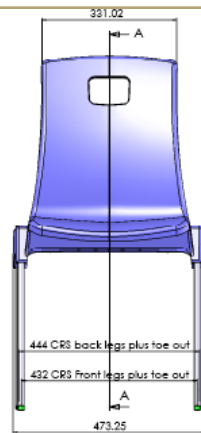

## Overview

ST chair's incorporate and comply with the latest aspects of European furniture design as influenced by the new European Education furniture standard EN1729. EN1729 was devised to address, and reduce the pain endured by many students associated with poorly postured, incorrect sized furniture. EN1729 relates specifically to classroom seating, and deals with the strength and stability of a chair, as it does the ergonomics associated with people of different sizes, sitting in that chair being used at a desk or table.

ST chair's have been designed for individual wellbeing and comfort. Comfortable, Hard Wearing, Easy to Handle, Purpose built furniture for today's student. Peace of mind for those that purchase and maintain that furniture

## Fabrication

Injection moulded Co-polymer Polypropylene seat shell textured to hide scratching and reinforced with in-mould structural ribs.

Legs manufactured from mild steel, powder coated then individually press fitted into the seat shell.

Non marking moulded polyethylene floor glides aid in stacking and minimise damage to floors.

Upholstered seat pad option fabricated using a formed plywood seat inner, upholstered in a choice of upholstery fabrics and vinyls, fastened to the seat shell by way of "T" nut fixings.

Moulded male and female linking devices manufactured from hard wearing nylon, screwed to the seat shell.

## Material

Seat shell manufactured from hardwearing co-polymer polypropylene.

Floor glides manufactured from moulded non skid polyethylene. (Different front and rear tip to aid in stacking)

Steel legs manufactured from 16 gauge flat oval mild steel, powder coated silver.

Male and Female Linking device manufactured from injection moulded nylon.

## Compliance

EN1729 parts 1 & 2 compliant for strength and stability and dimensional.

## Colour & Product Code

Shell colours: Slate (ST06SLA), Teal (ST06TEA), Soft Blue (ST06SBL), Primary Blue (ST06PBL), Plum (ST06PLU), Soft Lime (ST06SLI)  
Frame Colour: Silver

## Stacking

Recommended stack height 10 chairs (1.7 metre's stack height) . Stacked 16 high for transport only.

## Weight

4.2kg

## Options

Upholstered Seat pad. 0.3m upholstery fabric reqd.  
Trolley. Product code WAGCTROLLEY  
Links.

## Assembly

None Required

## Installation

None required

## Warranty

5 year manufacturers warranty.

## Maintenance

Easily cleaned with a damp cloth and a mild soap detergent

Linc Furniture Pty Ltd PO Box 856, Newport, NSW Australia  
P +61 419 257 254 F +61 2 9997 8114  
E sales@lincfurniture.com.au www.lincfurniture.com.au

Specifications subject to change without notice

**linc**  
FURNITURE®

# specificationsheet

ST chairs

size mark 5—430mm seat HT

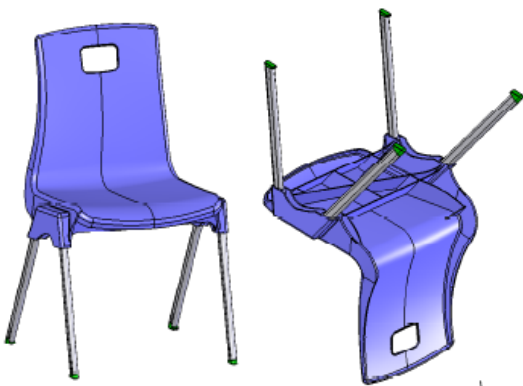

Model number ST05

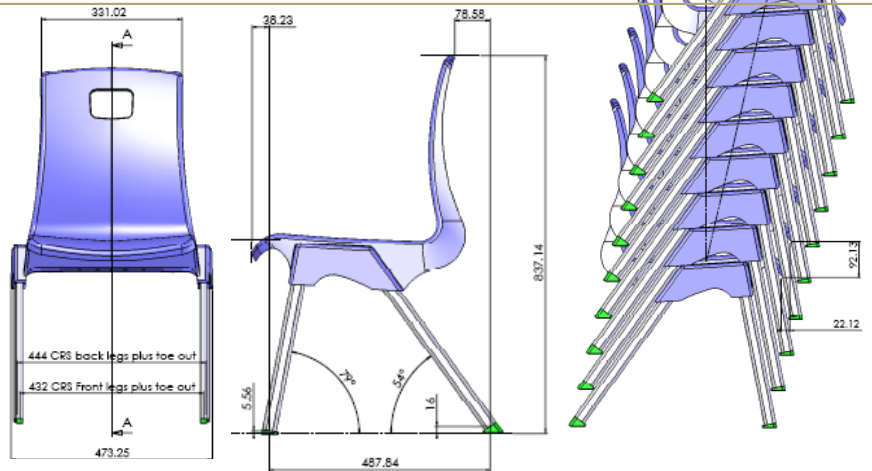

## Overview

ST chair's incorporate and comply with the latest aspects of European furniture design as influenced by the new European Education furniture standard EN1729 . EN1729 was devised to address, and reduce the pain endured by many students associated with poorly postured, incorrect sized furniture. EN1729 relates specifically to classroom seating, and deals with the strength and stability of a chair, as it does the ergonomics associated with people of different sizes, sitting in that chair being used at a desk or table.

ST chair's have been designed for individual wellbeing and comfort. Comfortable, Hard Wearing, Easy to Handle, Purpose built furniture for today's student. Peace of mind for those that purchase and maintain that furniture

## Fabrication

Injection moulded Co-polymer Polypropylene seat shell textured to hide scratching and reinforced with in -mould structural ribs.

Legs manufactured from mild steel, powder coated then individually press fitted into the seat shell.

Non marking moulded polyethylene floor glides aid in stacking and minimise damage to floors.

Upholstered seat pad option fabricated using a formed plywood seat inner, upholstered in a choice of upholstery fabrics and vinyls, fastened to the seat shell by way of "T" nut fixings.

Moulded male and female linking devices manufactured from hard wearing nylon, screwed to the seat shell.

## Material

Seat shell manufactured from hardwearing co-polymer polypropylene.

Floor glides manufactured from moulded non skid polyethylene. (Different front and rear tip to aid in stacking)

Steel legs manufactured from 16 gauge flat oval mild steel, powder coated silver.

Male and Female Linking device manufactured from injection moulded nylon.

## Compliance

EN1729 parts 1 & 2 compliant for strength and stability and dimensional.

## Colour & Product Code

Shell colours: Slate (ST05SLA), Teal (ST05TEA), Soft Blue (ST05SBL), Primary Blue (ST05PBL), Plum (ST05PLU), Soft Lime (ST05SLI)  
Frame Colour: Silver

## Stacking

Recommended stack height 10 chairs (1.67 metre's stack height) . Stacked 17 high for transport only.

## Weight

4.0kg

## Options

Upholstered Seat pad. 0.3m upholstery fabric reqd.  
Trolley. Product code WAGCTROLLEY  
Links.

## Assembly

None Required

## Installation

None required

## Warranty

5 year manufacturers warranty.

## Maintenance

Easily cleaned with a damp cloth and a mild soap detergent

Linc Furniture Pty Ltd PO Box 856, Newport, NSW Australia  
P +61 419 257 254 F +61 2 9997 8114  
E sales@lincfurniture.com.au www.lincfurniture.com.au

Specifications subject to change without notice

**linc**  
FURNITURE®

# specificationsheet

## ST chairs

size mark 4—380mm seat HT

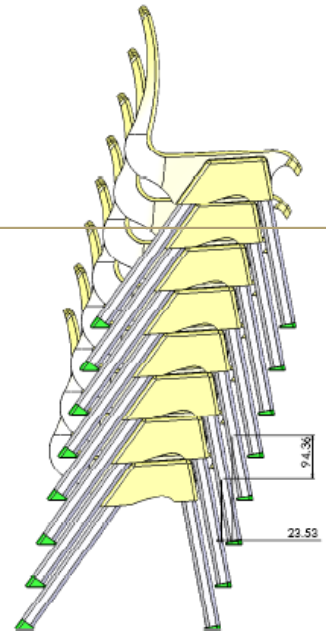
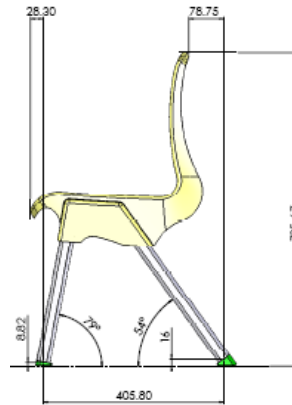
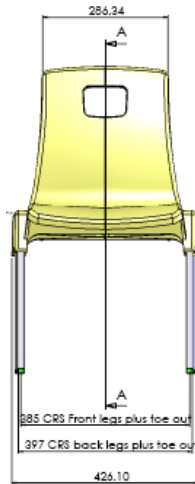
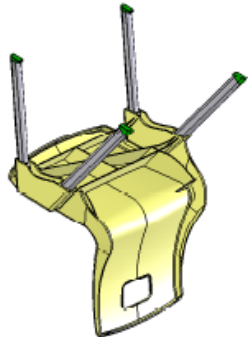
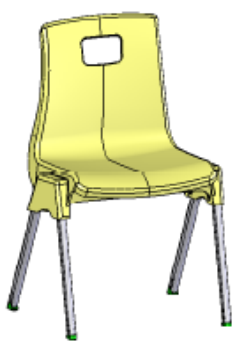

Model number ST04

### Overview

ST chair's incorporate and comply with the latest aspects of European furniture design as influenced by the new European Education furniture standard EN1729 . EN1729 was devised to address, and reduce the pain endured by many students associated with poorly postured, incorrect sized furniture. EN1729 relates specifically to classroom seating, and deals with the strength and stability of a chair, as it does the ergonomics associated with people of different sizes, sitting in that chair being used at a desk or table.

ST chair's have been designed for individual wellbeing and comfort. Comfortable, Hard Wearing, Easy to Handle, Purpose built furniture for today's student. Peace of mind for those that purchase and maintain that furniture

### Fabrication

Injection moulded Co-polymer Polypropylene seat shell textured to hide scratching and reinforced with in -mould structural ribs.

Legs manufactured from mild steel, powder coated then individually press fitted into the seat shell.

Non marking moulded polyethylene floor glides aid in stacking and minimise damage to floors.

### Material

Seat shell manufactured from hardwearing co-polymer polypropylene.

Floor glides manufactured from moulded non skid polyethylene. (Different front and rear tip to aid in stacking)

Steel legs manufactured from 16 gauge flat oval mild steel, powder coated silver.

### Compliance

EN1729 parts 1 & 2 compliant for strength and stability and dimensional.

### Colour & Product Code

Shell colours: Slate (ST04SLA), Teal (ST04TEA), Soft Blue (ST04SBL), Primary Blue (ST04PBL), Plum (ST04PLU), Soft Lime (ST04SLI)

Frame Colour: Silver

### Stacking

Recommended stack height 10 chairs (1.56 metre's stack height) . Stacked 19 high for transport only.

### Weight

3.3kg

### Options

Trolley.

Product code WAGCPORTERS

### Assembly

None Required

### Installation

None required

### Warranty

5 year manufacturers warranty.

### Maintenance

Easily cleaned with a damp cloth and a mild soap detergent

Linc Furniture Pty Ltd PO Box 856, Newport, NSW Australia  
P +61 419 257 254 F +61 2 9997 8114  
E sales@lincfurniture.com.au www.lincfurniture.com.au

Specifications subject to change without notice

**linc**  
FURNITURE®

# specificationsheet

## ST chairs

size mark 3—350mm seat HT

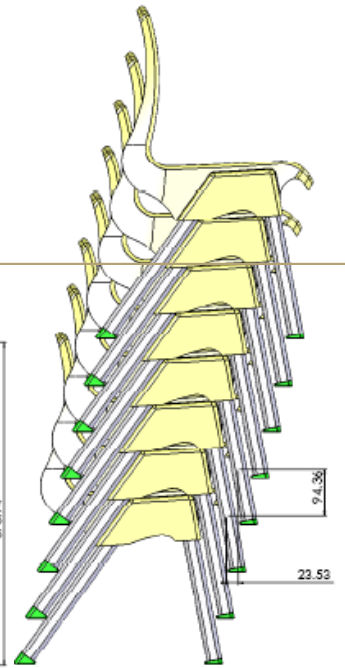
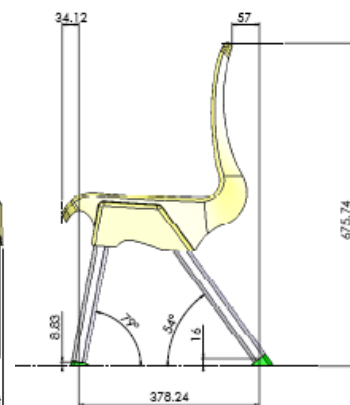
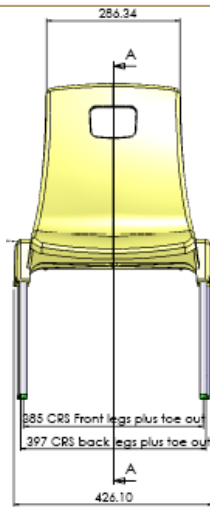
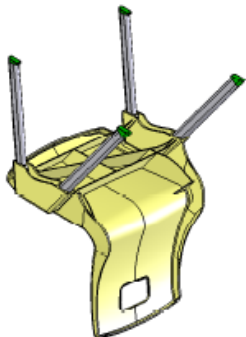

Model number ST03

### Overview

ST chair's incorporate and comply with the latest aspects of European furniture design as influenced by the new European Education furniture standard EN1729. EN1729 was devised to address, and reduce the pain endured by many students associated with poorly postured, incorrect sized furniture. EN1729 relates specifically to classroom seating, and deals with the strength and stability of a chair, as it does the ergonomics associated with people of different sizes, sitting in that chair being used at a desk or table.

ST chair's have been designed for individual wellbeing and comfort. Comfortable, Hard Wearing, Easy to Handle, Purpose built furniture for today's student. Peace of mind for those that purchase and maintain that furniture

### Fabrication

Injection moulded Co-polymer Polypropylene seat shell textured to hide scratching and reinforced with in-mould structural ribs.

Legs manufactured from mild steel, powder coated then individually press fitted into the seat shell.

Non marking moulded polyethylene floor glides aid in stacking and minimise damage to floors.

### Material

Seat shell manufactured from hardwearing co-polymer polypropylene.

Floor glides manufactured from moulded non skid polyethylene. (Different front and rear tip to aid in stacking)

Steel legs manufactured from 16 gauge flat oval mild steel, powder coated silver.

### Compliance

EN1729 parts 1 & 2 compliant for strength and stability and dimensional.

### Colour & Product Code

Shell colours: Slate (ST03SLA), Teal (ST03TEA), Soft Blue (ST03SBL), Primary Blue (ST03PBL), Plum (ST03PLU), Soft Lime (ST03SLI)

Frame Colour: Silver

### Stacking

Recommended stack height 10 chairs (1.53 metre's stack height) . Stacked 19 high for transport only.

### Weight

3.0kg

### Options

Trolley.

Product code WAGCPORTERS

### Assembly

None Required

### Installation

None required

### Warranty

5 year manufacturers warranty.

### Maintenance

Easily cleaned with a damp cloth and a mild soap detergent

Linc Furniture Pty Ltd PO Box 856, Newport, NSW Australia  
P +61 419 257 254 F +61 2 9997 8114  
E sales@lincfurniture.com.au www.lincfurniture.com.au

Specifications subject to change without notice

**linc**  
FURNITURE®

# specificationsheet

## ST chairs

size mark 2—310mm seat HT

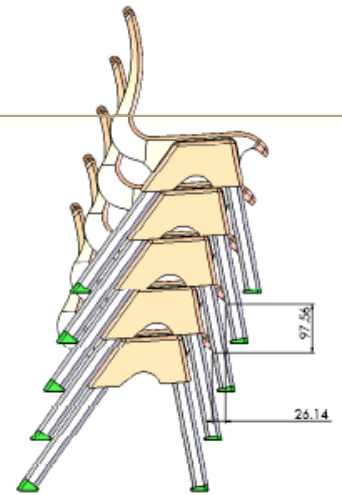
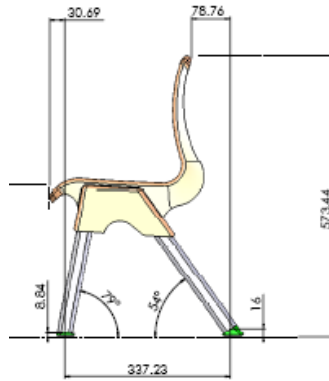
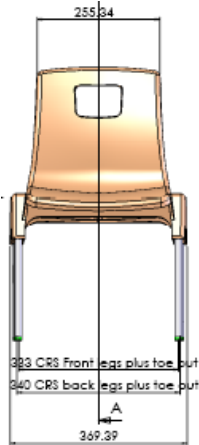
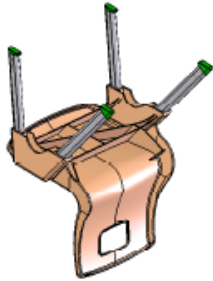

Model number ST02

### Overview

ST chair's incorporate and comply with the latest aspects of European furniture design as influenced by the new European Education furniture standard EN1729. EN1729 was devised to address, and reduce the pain endured by many students associated with poorly postured, incorrect sized furniture. EN1729 relates specifically to classroom seating, and deals with the strength and stability of a chair, as it does the ergonomics associated with people of different sizes, sitting in that chair being used at a desk or table.

ST chair's have been designed for individual wellbeing and comfort. Comfortable, Hard Wearing, Easy to Handle, Purpose built furniture for today's student. Peace of mind for those that purchase and maintain that furniture

### Fabrication

Injection moulded Co-polymer Polypropylene seat shell textured to hide scratching and reinforced with in-mould structural ribs.

Legs manufactured from mild steel, powder coated then individually press fitted into the seat shell.

Non marking moulded polyethylene floor glides aid in stacking and minimise damage to floors.

### Material

Seat shell manufactured from hardwearing co-polymer polypropylene.

Floor glides manufactured from moulded non skid polyethylene. (Different front and rear tip to aid in stacking)

Steel legs manufactured from 16 gauge flat oval mild steel, powder coated silver.

### Compliance

EN1729 parts 1 & 2 compliant for strength and stability and dimensional.

### Colour & Product Code

Shell colours: Slate (ST02SLA), Teal (ST02TEA), Soft Blue (ST02SBL), Primary Blue (ST02PBL), Plum (ST02PLU), Soft Lime (ST02SLI)

Frame Colour: Silver

### Stacking

Recommended stack height 10 chairs (1.46 metre's stack height) . Stacked 21 high for transport only.

### Weight

2.3kg

### Options

Trolley.

Product code WAGCPORTERS

### Assembly

None Required

### Installation

None required

### Warranty

5 year manufacturers warranty.

### Maintenance

Easily cleaned with a damp cloth and a mild soap detergent

Linc Furniture Pty Ltd PO Box 856, Newport, NSW Australia  
P +61 419 257 254 F +61 2 9997 8114  
E sales@lincfurniture.com.au www.lincfurniture.com.au

Specifications subject to change without notice

**linc**  
FURNITURE®

# specificationsheet

## ST chairs

size mark 1- 260mm seat HT

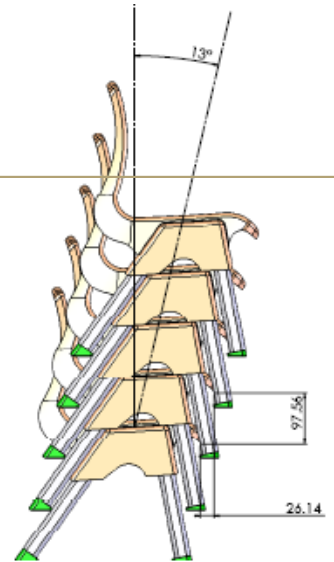
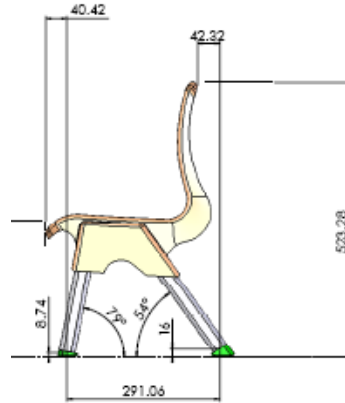
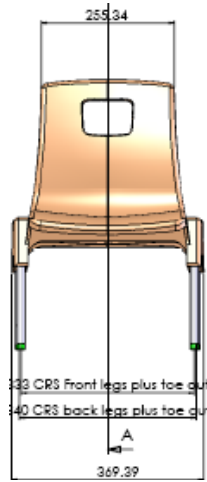
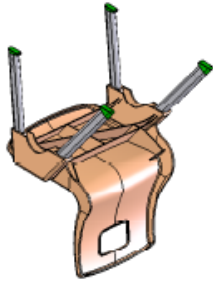

Model number ST01

### Overview

ST chair's incorporate and comply with the latest aspects of European furniture design as influenced by the new European Education furniture standard EN1729. EN1729 was devised to address, and reduce the pain endured by many students associated with poorly postured, incorrect sized furniture. EN1729 relates specifically to classroom seating, and deals with the strength and stability of a chair, as it does the ergonomics associated with people of different sizes, sitting in that chair being used at a desk or table.

ST chair's have been designed for individual wellbeing and comfort. Comfortable, Hard Wearing, Easy to Handle, Purpose built furniture for today's student. Peace of mind for those that purchase and maintain that furniture

### Fabrication

Injection moulded Co-polymer Polypropylene seat shell textured to hide scratching and reinforced with in-mould structural ribs.

Legs manufactured from mild steel, powder coated then individually press fitted into the seat shell.

Non marking moulded polyethylene floor glides aid in stacking and minimise damage to floors.

### Material

Seat shell manufactured from hardwearing co-polymer polypropylene.

Floor glides manufactured from moulded non skid polyethylene. (Different front and rear tip to aid in stacking)

Steel legs manufactured from 16 gauge flat oval mild steel, powder coated silver.

### Compliance

EN1729 parts 1 & 2 compliant for strength and stability and dimensional.

### Colour & Product Code

Shell colours: Slate (ST01SLA), Teal (ST01TEA), Soft Blue (ST01SBL), Primary Blue (ST01PBL), Plum (ST01PLU), Soft Lime (ST01SLI)

Frame Colour: Silver

### Stacking

Recommended stack height 10 chairs (1.41 metre's stack height) . Stacked 21 high for transport only.

### Weight

2.1kg

### Options

Trolley.

Product code WAGCPORTERS

### Assembly

None Required

### Installation

None required

### Warranty

5 year manufacturers warranty.

### Maintenance

Easily cleaned with a damp cloth and a mild soap detergent

Linc Furniture Pty Ltd PO Box 856, Newport, NSW Australia  
P +61 419 257 254 F +61 2 9997 8114  
E sales@lincfurniture.com.au www.lincfurniture.com.au

Specifications subject to change without notice

**linc**  
FURNITURE®